

TOP VIEW

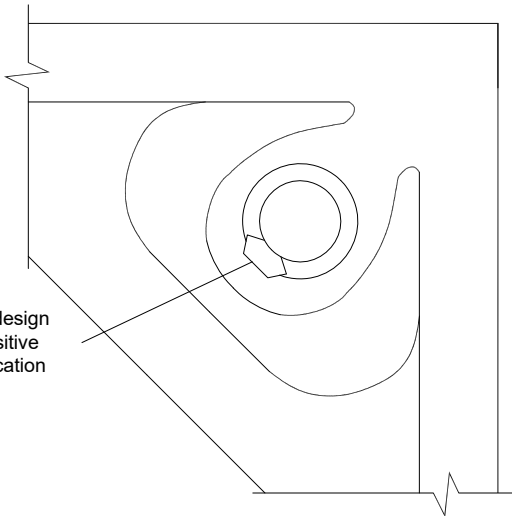

CORNER DETAIL

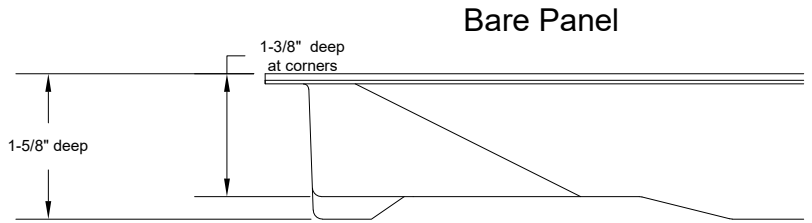

## SPECIFICATIONS

### General information

- Panel weight : 46,4kg/m2 bare.
- All steel welded construction filled internally with a cementitious core material.
- Protected from corrosion by an epoxy paint finish.
- Class A flame spread rating.

## UNDERSTRUCTURE OPTIONS

- 4' Bolted Stringer
- Posilock/Cornerlock
- 4' Box Stringer
- LFFH Posilock/Cornerlock

## COVERING OPTIONS

- Bare Painted Finish to accept carpet tile application
- Bare Painted Finish to accept PosiTite application

## FIELD APPLIED FREELAY OPTIONS

(REQUIRES RIGID UNDERLAYMENT, BY OTHERS)

- Freelay Resilient Tile
- Freelay Luxury Vinyl Tile (LVT) Planks

System Performance Criteria (Tested on Actual Understructure)								
System Type		SYSTEM WEIGHT	STATIC LOADS			ROLLING LOADS		IMPACT LOADS
Panel	Understructure		Design Loads	Ultimate Loads	Safety Factor	10 Passes	10,000 Passes	
ConCore 1500-60cm Bare	Posilock/Cornerlock	9.5 lbs / ft <sup>2</sup> 46.4 kg / m <sup>2</sup>	1500 lbs 680 kg	Min. 3000lbs Min.1360kg	Min. 2	1250 lbs 567 kg	900 lbs 408 kg	150 lbs 68 kg
	Posilock/Cornerlock	9.5 lbs / ft <sup>2</sup> 46.4 kg / m <sup>2</sup>	1500 lbs 680 kg	Min. 3000lbs Min.1360kg	Min. 2	1250 lbs 567 kg	900 lbs 408 kg	150 lbs 68 kg
	4' Bolted Stringer	10.5 lbs / ft <sup>2</sup> 51.3 kg / m <sup>2</sup>	1500 lbs 680 kg	Min. 3000lbs Min.1360kg	Min. 2	1250 lbs 567 kg	900 lbs 408 kg	150 lbs 68 kg
	4' Box Stringer	10.5 lbs / ft <sup>2</sup> 51.3 kg / m <sup>2</sup>	1500 lbs 680 kg	Min. 3000lbs Min.1360kg	Min. 2	1250 lbs 567 kg	900 lbs 408 kg	150 lbs 68 kg

1. System Design Load is based on permanent set  $\leq 0.010"$  and is verified by loading panels in accordance with the CISCA concentrated load method but with panels installed on actual understructure instead of steel blocks. (Testing on blocks does not represent performance of an actual installation.) Ultimate, Rolling, and Impact Load tests are performed using CISCA test procedures.

2. Safety Factor is Ultimate Load divided by Design Load.

3. Published load ratings do not apply to perimeter, cut panels or panels with cutouts.



Tate reserves the right to amend product information without prior notice. Care has been taken to ensure that the contents of this publication are accurate, but Tate, its parent company and its subsidiary companies do not accept responsibility for errors or information that is found to be misleading or outdated. Suggestions for, or descriptions of, technical specifications and the end user or application of products are provided and must be verified prior to use. To ensure you are viewing the most recent and accurate product information, please scan the QR code.